

Dell Wyse Cloud Client

Wyse 5020

Quick Start Guide



1 Install the vertical stand

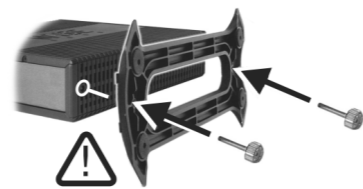

Or use Dell-approved mounting accessory kit

2 Connect the keyboard and mouse

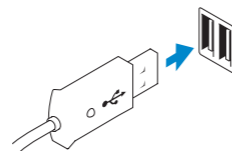

USB Connector

3 Connect the network

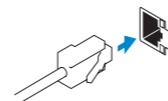

Network connector

Or

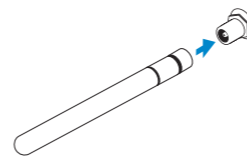

Wireless antenna

Or

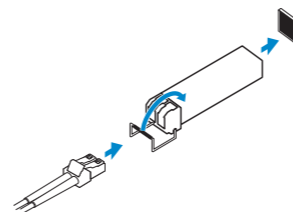

Fiber SFP module

NOTE: To remove the Fibre SFP module, rotate the latch and unplug it from its slot.

Product support and manuals

dell.com/support
dell.com/support/manuals

Contact Dell

dell.com/contactdell

Regulatory and safety

dell.com/regulatory_compliance

Regulatory model

Dx0Q

Client device model

Dell Wyse Cloud Client
Wyse 5020



0DGR40A00

© 2015 Dell Inc.

Printed in China.
2015-05

4 Connect the display

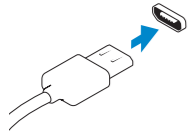

Display Port connector

Or

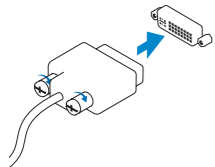

DVI-I connector

Or

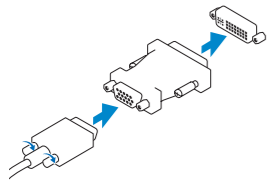

VGA adapter

5 Connect the power cable on your client device and display

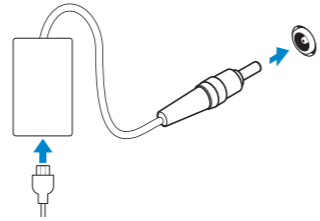

Client device power connector

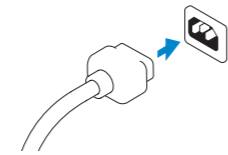

Display power connector

NOTE: Your client device is ready to use when the client device activity light goes off.

6 Turn on your client device and display

Features

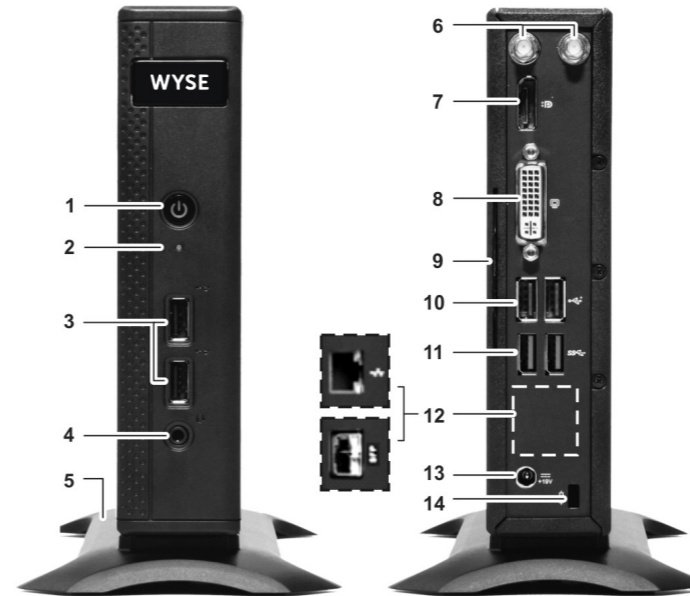

- | | |
|--|---|
| 1. Power on/off button and light | 11. Super speed USB 3.0 port (2x) |
| 2. Activity light | 12. Network port, 10/100/1000 Base-T or SFP |
| 3. USB 2.0 port (2x) | 13. +19V Power adapter input |
| 4. Headphone/microphone jack | 14. Lock receptacle |
| 5. Vertical stand | |
| 6. Wireless antenna port (2x) (optional) | |
| 7. Display Port connector | |
| 8. DVI-I port [1x DVI-D / 1x VGA] | |
| 9. Product information tab | |
| 10. USB 2.0 port (2x) | |



NOTE: Components may vary based on model and location.

NOTE: For more information see the *Administrator's Guide* at www.dell.com/support.